



3



1



2



C



Description

Robert Luff & Co are pleased to offer this well presented three bedroom end terrace house located in popular South Goring. Upstairs accommodation comprises three generously sized bedrooms and a modern family bathroom. Downstairs living includes a large kitchen/diner, lounge, W/C and store room. The property also benefits a well maintained rear garden, off road parking, double glazing and gas fired central heating.



Key Features

- End Terrace House
- Downstairs W.C
- Kitchen / Diner
- Freehold
- Council Tax Band - C
- Three Bedrooms
- Residents Parking
- Beautifully Finished
- EPC - C





Entrance Hall

Lounge

3.29 x 4.87 (10'9" x 15'11")

Kitchen / Diner

3.0 x 5.38 (9'10" x 17'7")

W.C

1.49 x 0.85 (4'10" x 2'9")

Store Room

2.14 x 1.94 (7'0" x 6'4")

First Floor Landing

Bedroom One

2.98 x 5.02 (9'9" x 16'5")



Bedroom Two

2.66 x 3.75 (8'8" x 12'3")

Bedroom Three

2.85 x 2.13 (9'4" x 6'11")

Bathroom

2.35 x 1.81 (7'8" x 5'11")

Front Garden

Laid to lawn with low level fence, path to front door.

Rear Garden

Mainly laid to lawn, raised decked area, rear access

Parking

Residents parking to rear, four permits available.

robertluff.co.uk

2 Boxgrove Parade Goring, Worthing, West Sussex, BN12 6BR | 01903 331567 | goring@robertluff.co.uk

Robert
Luff & Co

Floor Plan Palmerston Avenue

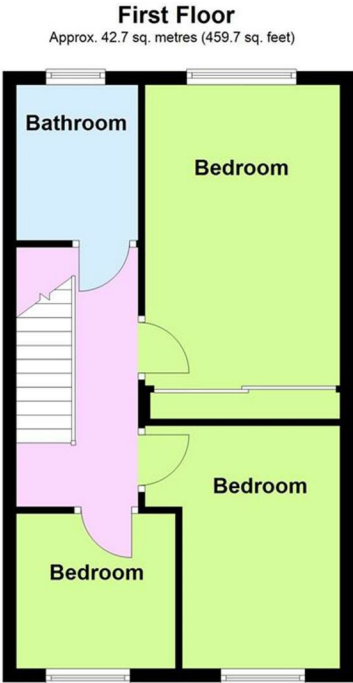
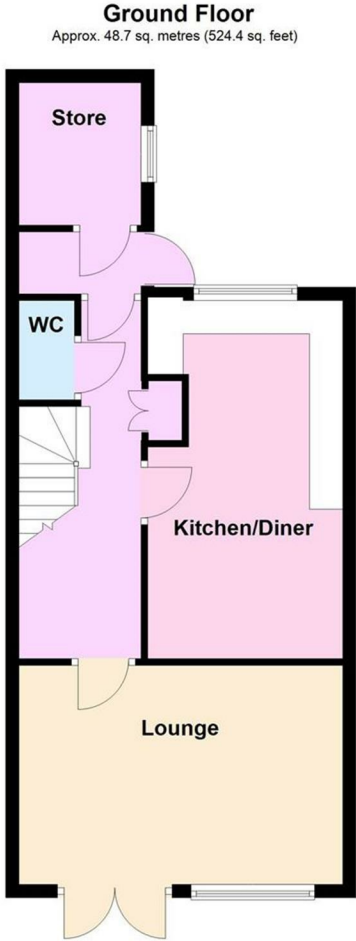

Total area: approx. 91.4 sq. metres (984.1 sq. feet)

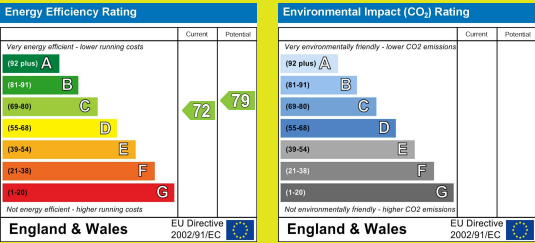

The information provided about this property does not constitute or form any part of an offer or contract, nor may it be regarded as representations. All interested parties must verify accuracy and your solicitor must verify tenure/lease information, fixtures and fittings and, where the property has been extended/converted, planning/building regulation consents. All dimensions are approximate and quoted for guidance only as are floor plans which are not to scale and their accuracy cannot be confirmed. References to appliances and/or services does not imply that they are necessarily in working order or fit for the purpose.